

### SAMPLE FLOOR PLAN

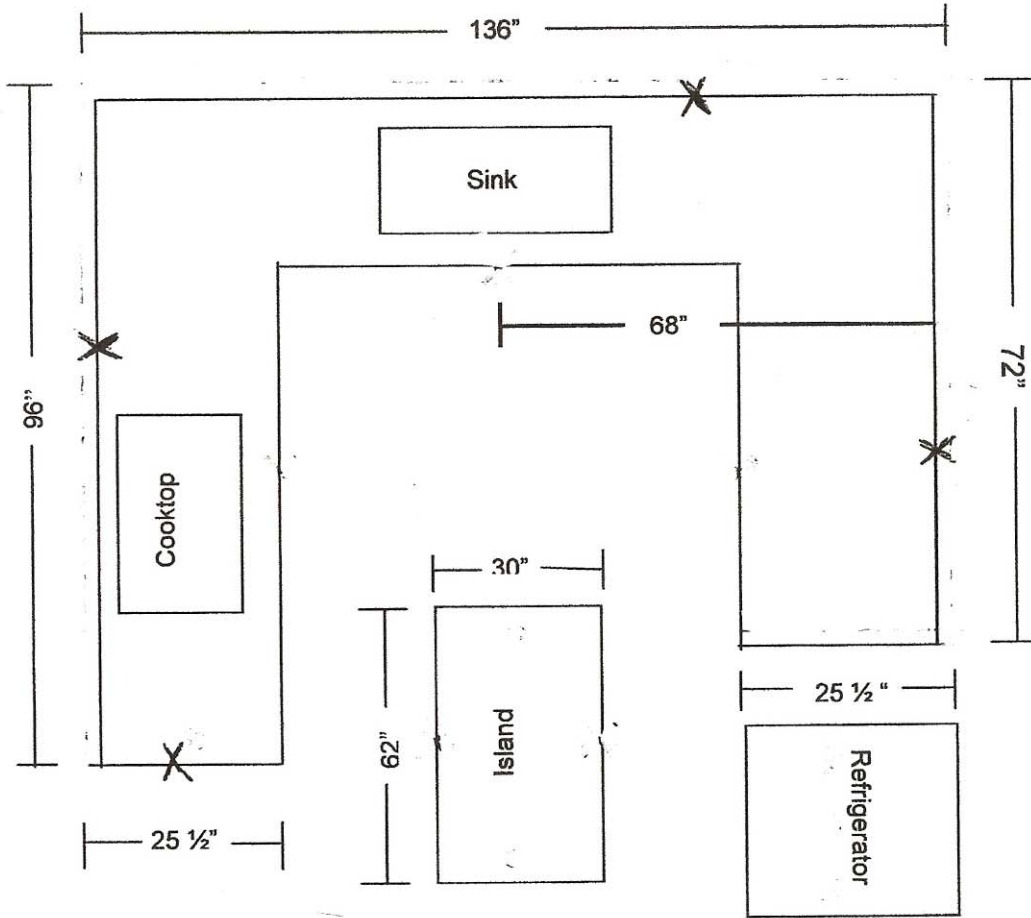

Area: Kitchen  
 Stone: Baltic Brown

Sink type: Drop in - Stainless steel  
 Range or Cook top: Cook top

1. We need the total length and depth of countertop or tops in inches.
2. We will need to know the approximate sink location and cook top location if applicable.
3. Label whether edge is wall or finished.
4. Label where range and refrigerator are located in countertop configuration.
5. Measure longest edge of angled countertops - see example below
6. Label if countertops are at different levels. i.e. raised bars, desks etc.
7. Drawings do not need to be to scale.
8. Mark back splash walls and end panels with **X** as shown on sample.

